

FILTER OVERVIEW WITH SERVICE INTERVALS AND CAPACITIES

5E iT4 and FT4 Series Utility Tractors - 5085E and 5100E

CAB

RECIRCULATION AIR FILTER
[RE195491](#)
 RECIRCULATION W/O A.C. AIR
 FILTER – [R198887](#)

Clean annually and as required
 per conditions.

Quantity 2

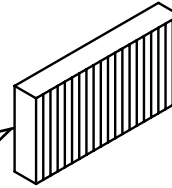
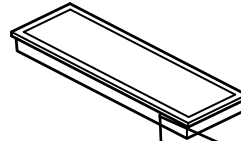

CAB

FRESH AIR FILTER [RE198488](#)

Clean annually and as required per conditions.

Quantity 2

ENGINE

DIESEL EXHAUST FLUID (DEF)
 DOSING UNIT FILTER [RE554498](#)

Replace after every 4500 hours
 or every five years of operation,
 whichever occurs first.

(Click here for [capacity](#))



ENGINE

DIESEL PARTICULATE FILTER (DPF)
[RE568454](#) (iT4)

See dealer for service.

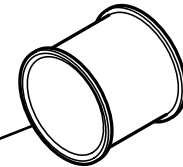

HYDRAULIC

OIL FILTER [RE197065](#)

Initial replacement after 100 hours,
 then replace every 600 hours and
 1200hours.

(Click here for [capacity](#))

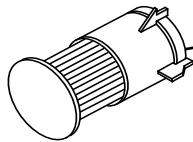

ENGINE

PRIMARY AIR FILTER
[SU20768](#)

SECONDARY AIR FILTER
[RE253519](#)

Service after every 1200 hours or annually
 as required per conditions.

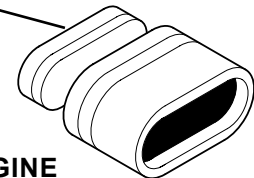

ENGINE

PRIMARY FUEL FILTER
[RE546336](#) (iT4)
[RE560682](#) (FT4)

SECONDARY FUEL FILTER
[RE544394](#) (iT4)
[RE551508](#) (FT4)

Replace after every 500 hours.
 Replace as required..

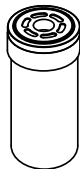

ENGINE

OPEN CRANKCASE VENTILATION
 (OCV) FILTER
 (IT4/FT4 ENGINE W/DIESEL OXI-
 DATION CATALYST (DOC)/DIESEL
 PARTICULATE FILTER (DPF))

[DZ105100](#)

(IT4/FT4 ENGINE W/DIESEL OXI-
 DATION CATALYST (DOC) ONLY)
[DZ105796](#)

Replace as required.

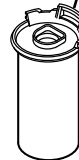

ENGINE

OIL FILTER [RE504836](#)

Initial replacement after 100 hours
 and then replace every 300 hours.
 If using Plus-50™ II 15-40,replace
 every 500 hours.

(Click here for [capacity](#))

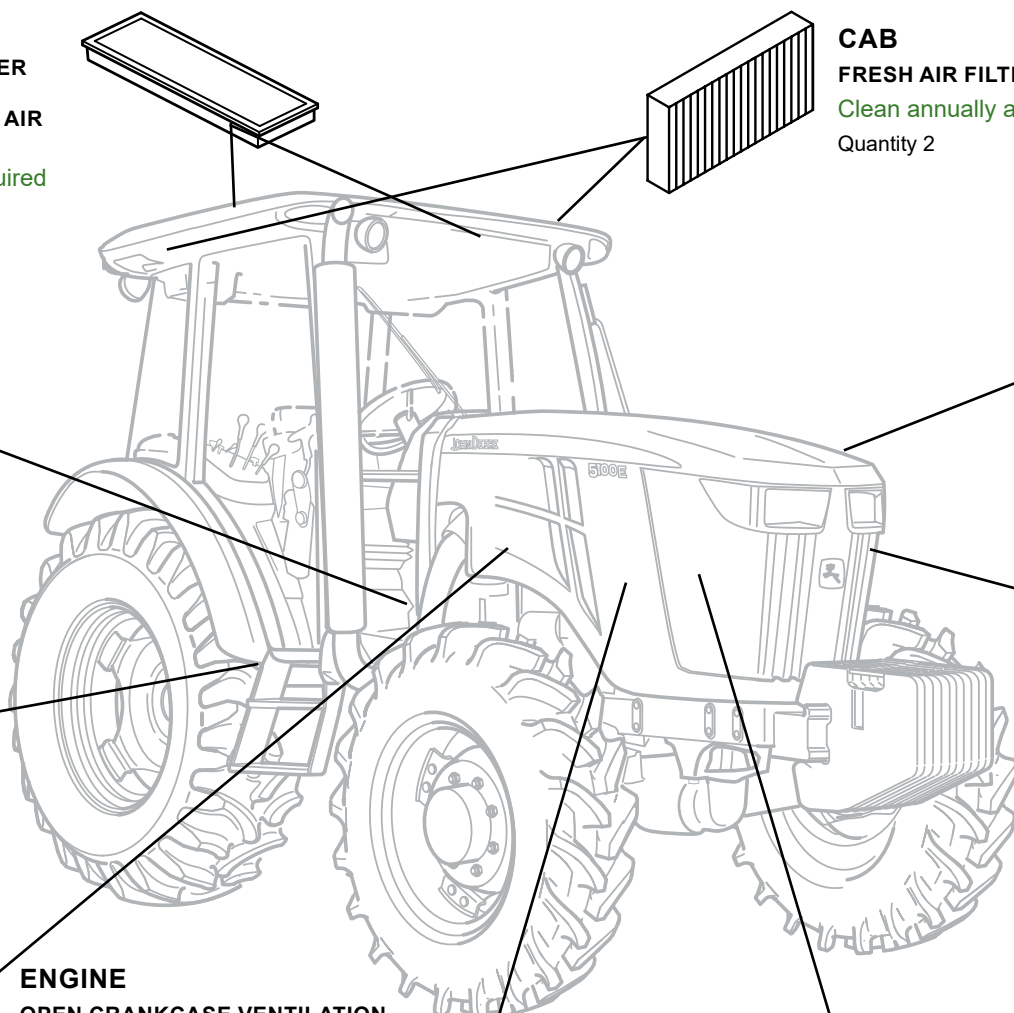

JOHN DEERE

Genuine Parts and Service

CAPACITIES

5E iT4 and FT4 Series Utility Tractors - 5085E and 5100E

CAPACITIES (Approximate):

Fuel Tank:

Open Operator Station 96 L (25 gal)
Cab 115 L (30 gal)

Cooling System:

Cool-Gard™ II
..... 11.4 L (3 gal)

Crankcase with Filter:

Plus-50™ II
..... 11 L (2.9 gal)

Transmission and Hydraulic System:

Hy-Gard™
..... 43.5 L (11.5 gal)

Mechanical Front Wheel Drive (MFWD) Axle:

Hy-Gard™
Differential Housing 5 L (1.3 gal)
Wheel Hub (Each) 0.7 L (0.18 gal)

[Return to Filter Overview](#)

